

TYPICAL CONSTRUCTION SIGN INSTALLATIONS

NOTES:

1. SIGNING DETAILS SHOWN ON THIS SHEET ARE INTENDED TO CONVEY TYPICAL CONDITIONS ONLY. SPECIFIC LOCATIONS MAY REQUIRE INSTALLATIONS DIFFERENT FROM THOSE SHOWN HERE.
2. IF THE MAXIMUM DIMENSION OF A SIGN IS 36" OR LESS, USE A 4"x4" POST. IF THE MAXIMUM DIMENSION EXCEEDS 36", USE A 4"x6" POST. FOR MOUNTING PLYWOOD OR SHEET ALUMINUM SIGNS ON WOODEN POSTS, USE 3/8"x3" GALVANIZED LAG BOLTS WITH STAINLESS STEEL OR NEOPRENE WASHERS.
3. STOP SIGNS SHALL ALWAYS BE INSTALLED AT 6.0'-8.0' VERTICAL CLEARANCE.
4. USE 4.0' MINIMUM VERTICAL CLEARANCE ONLY IF SECONDARY SIGN IS 24" OR LESS IN WIDTH.
5. FOR INSTALLATION IN HARD-SURFACED AREAS, ALTERNATIVE POST INSTALLATIONS MAY BE USED WITH APPROVAL OF THE ENGINEER.
6. IF BOTTOM OF SIGN IS INSTALLED LESS THAN 7' ABOVE THE SIDEWALK, IT MAY EXTEND A MAXIMUM OF 4" INTO PEDESTRIAN PATHWAY.
7. FOR ADDITIONAL INFORMATION REGARDING LOCATION AND INSTALLATION OF SIGNS AND POSTS, CONSULT THE CURRENT MANUAL OF UNIFORM TRAFFIC CONTROL DEVICES (M.U.T.C.D.) AND OREGON TEMPORARY TRAFFIC CONTROL HANDBOOK.

CITY of LEBANON 2021 SUPPLEMENTAL STANDARD DRAWING



APPROVED

[Handwritten Signature]

CITY ENGINEER

December, 2021

DATE

TEMPORARY
(CONSTRUCTION)
SIGNING

DRAWING NO:

00200-01

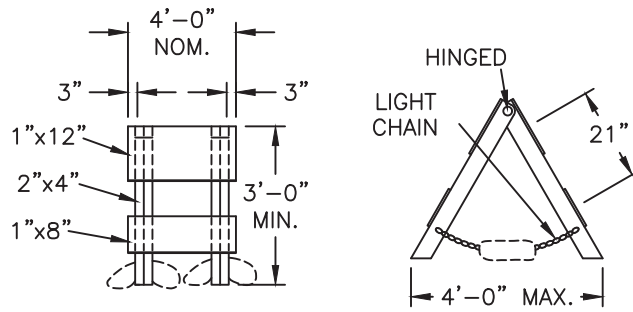

BARRICADE – TYPE II

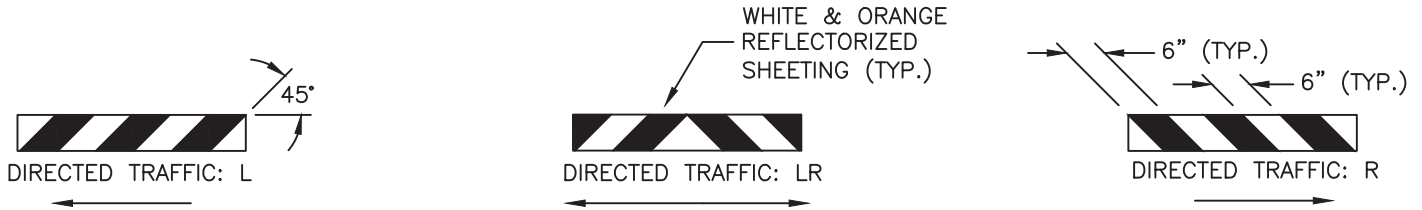

SLOPE DIRECTION DIAGRAM FOR BARRICADE MARKING

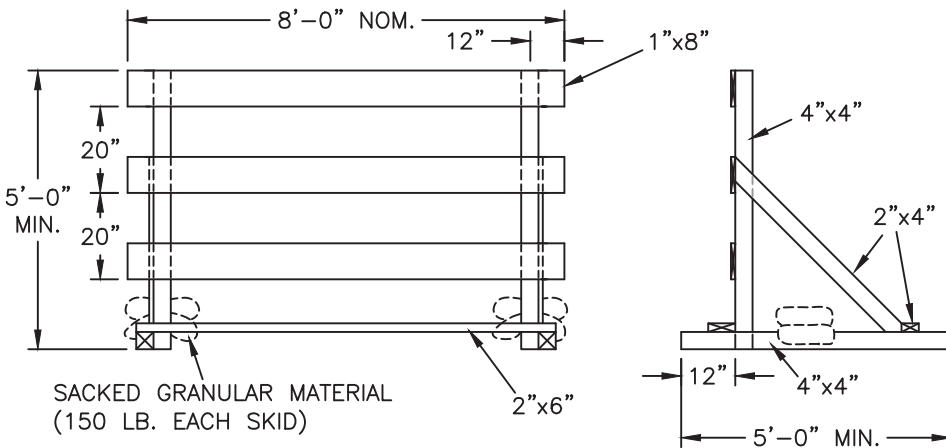

BARRICADE – TYPE III

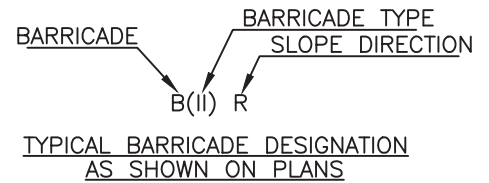

NOTES:

1. REFLECTORIZED STRIPING ON BARRICADE RAILS SHALL SLOPE DOWNWARD AT A 45° ANGLE IN THE DIRECTION TRAFFIC IS TO PASS. WHERE BARRICADES EXTEND ENTIRELY ACROSS A ROADWAY, STRIPING SHALL SLOPE DOWNWARDS IN THE DIRECTION TRAFFIC IS TO DETOUR. WHERE TRAFFIC IS PERMITTED TO DETOUR IN MULTIPLE DIRECTIONS, STRIPING SHALL SLOPE IN BOTH DIRECTIONS FROM THE CENTER OF THE BARRICADE.
2. ALTERNATE METHODS AND MATERIALS MAY BE PERMITTED WITH APPROVAL OF THE ENGINEER.
3. ALL BARRICADES SHALL BE WEIGHTED AS SHOWN OR AS DIRECTED BY THE ENGINEER. BARRICADES MANUFACTURED FROM STEEL POSTS WITH PLASTIC BARRICADE RAILS SHALL BE WEIGHTED ON BOTH SIDES OF THE BARRICADE FACE TO PREVENT KNOCK-DOWN.
4. FOR RAIL LENGTHS LESS THAN 3 FEET, 4" WIDE STRIPES MAY BE SUBSTITUTED.
5. BARRICADE DIMENSIONS ARE AS SHOWN, UNLESS OTHERWISE INDICATED IN THE PROJECT PLANS & SPECIFICATIONS.
6. FOR FULL ROADWAY CLOSURES, THE LR BARRICADE MAY BE USED. EXTEND BARRICADES COMPLETELY ACROSS ROADWAY UNLESS ACCESS IS REQUIRED FOR LOCAL ACCESS.

CITY of LEBANON 2021 SUPPLEMENTAL STANDARD DRAWING



APPROVED

[Signature]

CITY ENGINEER

December, 2021

DATE

TEMPORARY
(CONSTRUCTION)
BARRICADES

DRAWING NO:

00200-02